

PRODUCT CHANGE NOTIFICATION

PCN Number: 630

Date of Issue:	7/29/22
PCN Effective Date:	7/29/22
Last Time Buy Date:	-
Last Time Ship Date:	-
Type of Change:	MATL
Title of Change:	Material Update
Description and Reason for Change:	<p>The lock washer has been updated on the data sheets to reflect the correct material description. The lens retaining ring UL rating has changed from UL 94-V0 to UL 94-HB for the part numbers listed below.</p> <p>Fit, form, function, are not affected.</p>

Mario Davila

Product Manager:  _____

AFFECTED PART NUMBER(S)

Manufacturer Part Number (MPN)	Description	Discontinued per PCN	Suggested Alternative Part Number(s)	Description of the Difference
CMC_441_ATP	PLC Lens 5mm 0.312" Round Fresnel Amber	No	-	The lock washer has been updated on the data sheet to reflect the correct material description. The lens retaining ring UL rating has changed from UL 94-V0 to UL 94-HB.
CMC_441_BTP	PLC Lens 5mm 0.312" Round Fresnel Blue	No	-	The lock washer has been updated on the data sheet to reflect the correct material description. The lens retaining ring UL rating has changed from UL 94-V0 to UL 94-HB.
CMC_441_CTP	PLC Lens 5mm 0.312" RND Clear	No	-	The lock washer has been updated on the data sheet to reflect the correct material description. The lens retaining ring UL rating has changed from UL 94-V0 to UL 94-HB.
CMC_441_GTP	PLC Lens 5mm 0.312" RND Green	No	-	The lock washer has been updated on the data sheet to reflect the correct material description. The lens retaining ring UL rating has changed from UL 94-V0 to UL 94-HB.
CMC_441_RTP	PLC Lens 5mm 0.312" RND Red	No	-	The lock washer has been updated on the data sheet to reflect the correct material description. The lens retaining ring UL rating has changed from UL 94-V0 to UL 94-HB.
CMC_441_YTP	PLC Lens 5mm 0.312" RND Yellow	No	-	The lock washer has been updated on the data sheet to reflect the correct material description. The lens retaining ring UL rating has changed from UL 94-V0 to UL 94-HB.

CMC_443_CTP	PLC Lens 5mm 0.312" Round Clear	No	-	The lock washer has been updated on the data sheet to reflect the correct material description. The lens retaining ring UL rating has changed from UL 94-V0 to UL 94-HB.
CMS_442_ATP	PLC Lens 5mm 0.312" RND Amber NEMA4	No	-	The lock washer has been updated on the data sheet to reflect the correct material description. The lens retaining ring UL rating has changed from UL 94-V0 to UL 94-HB.
CMS_442_BTP	PLC Lens 5mm 0.312" RND Blue NEMA4	No	-	The lock washer has been updated on the data sheet to reflect the correct material description. The lens retaining ring UL rating has changed from UL 94-V0 to UL 94-HB.
CMS_442_CTP	PLC Lens 5mm 0.312" RND Clear NEMA4	No	-	The lock washer has been updated on the data sheet to reflect the correct material description. The lens retaining ring UL rating has changed from UL 94-V0 to UL 94-HB.
CMS_442_GTP	PLC Lens 5mm 0.312" RND Green NEMA4	No	-	The lock washer has been updated on the data sheet to reflect the correct material description. The lens retaining ring UL rating has changed from UL 94-V0 to UL 94-HB.
CMS_442_RTP	PLC Lens 5mm 0.312" RND Red NEMA4	No	-	The lock washer has been updated on the data sheet to reflect the correct material description. The lens retaining ring UL rating has changed from UL 94-V0 to UL 94-HB.
CMS_442_YTP	PLC Lens 5mm 0.312" RND Yellow NEMA4	No	-	The lock washer has been updated on the data sheet to reflect the correct material description. The lens retaining ring UL rating has changed from UL 94-V0 to UL 94-HB.

CMS_444_CTP	PLC Lens 5mm 0.312" RND Clear	No	-	The lock washer has been updated on the data sheet to reflect the correct material description. The lens retaining ring UL rating has changed from UL 94-V0 to UL 94-HB.
FLX_441_RTP_06	LTP Flex RND .312"D 6.0"L Red	No	-	The lock washer has been updated on the data sheet to reflect the correct material description. The lens retaining ring UL rating has changed from UL 94-V0 to UL 94-HB.
FLX_442_CTP_04	LTP Flex RND .312"D 4"L CLR MS	No	-	The lock washer has been updated on the data sheet to reflect the correct material description. The lens retaining ring UL rating has changed from UL 94-V0 to UL 94-HB.
FLX_442_CTP_06	LTP Flex RND .312"D 6"L CLR MS	No	-	The lock washer has been updated on the data sheet to reflect the correct material description. The lens retaining ring UL rating has changed from UL 94-V0 to UL 94-HB.
FLX_442_CTP_12	LTP Flex RND .312"D 12"L CLR MS	No	-	The lock washer has been updated on the data sheet to reflect the correct material description. The lens retaining ring UL rating has changed from UL 94-V0 to UL 94-HB.
FLX_442_GTP_12	LTP Flex RND .312"D 12"L Green MS	No	-	The lock washer has been updated on the data sheet to reflect the correct material description. The lens retaining ring UL rating has changed from UL 94-V0 to UL 94-HB.
LCS_032_ATP	LTP Rigid RND .313"D .32"L Amber MS	No	-	The lock washer has been updated on the data sheet to reflect the correct material description. The lens retaining ring UL rating has changed from UL 94-V0 to UL 94-HB.

LCS_032_CTP	LTP Rigid Panel RND .313"D .32"L MS	No	-	The lock washer has been updated on the data sheet to reflect the correct material description. The lens retaining ring UL rating has changed from UL 94-V0 to UL 94-HB.
LCS_032_GTP	LTP Rigid RND .313"D .32"L Green MS	No	-	The lock washer has been updated on the data sheet to reflect the correct material description. The lens retaining ring UL rating has changed from UL 94-V0 to UL 94-HB.
LCS_032_RTP	LTP Rigid Panel RND .313"D .32"L RED MS	No	-	The lock washer has been updated on the data sheet to reflect the correct material description. The lens retaining ring UL rating has changed from UL 94-V0 to UL 94-HB.
LCS_032_YTP	LTP Rigid RND .313"D .32"L Yellow MS	No	-	The lock washer has been updated on the data sheet to reflect the correct material description. The lens retaining ring UL rating has changed from UL 94-V0 to UL 94-HB.
LCS_052_ATP	LTP Rigid RND .313"D .52"L Amber MS	No	-	The lock washer has been updated on the data sheet to reflect the correct material description. The lens retaining ring UL rating has changed from UL 94-V0 to UL 94-HB.
LCS_052_BTP	LTP Rigid Panel RND .313"D .52"L Blue MS	No	-	The lock washer has been updated on the data sheet to reflect the correct material description. The lens retaining ring UL rating has changed from UL 94-V0 to UL 94-HB.
LCS_052_CTP	LTP Rigid Panel RND .313"D .52"L MS	No	-	The lock washer has been updated on the data sheet to reflect the correct material description. The lens retaining ring UL rating has changed from UL 94-V0 to UL 94-HB.

LCS_052_GTP	LTP Rigid RND .313"D .52"L Green MS	No	-	The lock washer has been updated on the data sheet to reflect the correct material description. The lens retaining ring UL rating has changed from UL 94-V0 to UL 94-HB.
LCS_052_RTP	LTP Rigid Panel RND .313"D .52"L RED MS	No	-	The lock washer has been updated on the data sheet to reflect the correct material description. The lens retaining ring UL rating has changed from UL 94-V0 to UL 94-HB.
LCS_052_YTP	LTP Rigid RND .313"D .52"L Yellow MS	No	-	The lock washer has been updated on the data sheet to reflect the correct material description. The lens retaining ring UL rating has changed from UL 94-V0 to UL 94-HB.
LCS_072_ATP	LTP Rigid RND .313"D .72"L Amber MS	No	-	The lock washer has been updated on the data sheet to reflect the correct material description. The lens retaining ring UL rating has changed from UL 94-V0 to UL 94-HB.
LCS_072_BTP	LTP Rigid Panel RND .313"D .72"L Blue MS	No	-	The lock washer has been updated on the data sheet to reflect the correct material description. The lens retaining ring UL rating has changed from UL 94-V0 to UL 94-HB.
LCS_072_CTP	LTP Rigid Panel RND .313"D .72"L MS	No	-	The lock washer has been updated on the data sheet to reflect the correct material description. The lens retaining ring UL rating has changed from UL 94-V0 to UL 94-HB.
LCS_072_GTP	LTP Rigid RND .313"D .72"L Green MS	No	-	The lock washer has been updated on the data sheet to reflect the correct material description. The lens retaining ring UL rating has changed from UL 94-V0 to UL 94-HB.

LCS_072_RTP	LTP Rigid Panel RND .313"D .72"L RED MS	No	-	The lock washer has been updated on the data sheet to reflect the correct material description. The lens retaining ring UL rating has changed from UL 94-V0 to UL 94-HB.
LCS_072_YTP	LTP Rigid RND .313"D .72"L Yellow MS	No	-	The lock washer has been updated on the data sheet to reflect the correct material description. The lens retaining ring UL rating has changed from UL 94-V0 to UL 94-HB.
LCS_092_ATP	LTP Rigid RND .313"D .92"L Amber MS	No	-	The lock washer has been updated on the data sheet to reflect the correct material description. The lens retaining ring UL rating has changed from UL 94-V0 to UL 94-HB.
LCS_092_BTP	LTP Rigid Panel RND .313"D .92"L Blue MS	No	-	The lock washer has been updated on the data sheet to reflect the correct material description. The lens retaining ring UL rating has changed from UL 94-V0 to UL 94-HB.
LCS_092_CTP	LTP Rigid Panel RND .313"D .92"L MS	No	-	The lock washer has been updated on the data sheet to reflect the correct material description. The lens retaining ring UL rating has changed from UL 94-V0 to UL 94-HB.
LCS_092_GTP	LTP Rigid RND .313"D .92"L Green MS	No	-	The lock washer has been updated on the data sheet to reflect the correct material description. The lens retaining ring UL rating has changed from UL 94-V0 to UL 94-HB.
LCS_092_RTP	LTP Rigid Panel RND .313"D .92"L RED MS	No	-	The lock washer has been updated on the data sheet to reflect the correct material description. The lens retaining ring UL rating has changed from UL 94-V0 to UL 94-HB.

LCS_092_YTP	LTP Rigid RND .313"D .92"L Yellow MS	No	-	The lock washer has been updated on the data sheet to reflect the correct material description. The lens retaining ring UL rating has changed from UL 94-V0 to UL 94-HB.
LCS_112_ATP	LTP Rigid RND .313"D 1.12"L Amber MS	No	-	The lock washer has been updated on the data sheet to reflect the correct material description. The lens retaining ring UL rating has changed from UL 94-V0 to UL 94-HB.
LCS_112_BTP	LTP Rigid RND .313"D 1.12"L Blue MS	No	-	The lock washer has been updated on the data sheet to reflect the correct material description. The lens retaining ring UL rating has changed from UL 94-V0 to UL 94-HB.
LCS_112_CTP	LTP Rigid Panel RND .313"D 1.12"L MS	No	-	The lock washer has been updated on the data sheet to reflect the correct material description. The lens retaining ring UL rating has changed from UL 94-V0 to UL 94-HB.
LCS_112_GTP	LTP Rigid RND .313"D 1.12"L Green MS	No	-	The lock washer has been updated on the data sheet to reflect the correct material description. The lens retaining ring UL rating has changed from UL 94-V0 to UL 94-HB.
LCS_112_RTP	LTP Rigid Panel RND .313"D 1.12"L RED MS	No	-	The lock washer has been updated on the data sheet to reflect the correct material description. The lens retaining ring UL rating has changed from UL 94-V0 to UL 94-HB.
LCS_112_YTP	LTP Rigid RND .313"D 1.12"L Yellow MS	No	-	The lock washer has been updated on the data sheet to reflect the correct material description. The lens retaining ring UL rating has changed from UL 94-V0 to UL 94-HB.

LCS_132_ATP	LTP Rigid RND .313"D 1.32"L Amber MS	No	-	The lock washer has been updated on the data sheet to reflect the correct material description. The lens retaining ring UL rating has changed from UL 94-V0 to UL 94-HB.
LCS_132_BTP	LTP Rigid RND .313"D 1.32"L Blue MS	No	-	The lock washer has been updated on the data sheet to reflect the correct material description. The lens retaining ring UL rating has changed from UL 94-V0 to UL 94-HB.
LCS_132_CTP	LTP Rigid Panel RND .313"D 1.32"L MS	No	-	The lock washer has been updated on the data sheet to reflect the correct material description. The lens retaining ring UL rating has changed from UL 94-V0 to UL 94-HB.
LCS_132_GTP	LTP Rigid RND .313"D 1.32"L Green MS	No	-	The lock washer has been updated on the data sheet to reflect the correct material description. The lens retaining ring UL rating has changed from UL 94-V0 to UL 94-HB.
LCS_132_RTP	LTP Rigid Panel RND .313"D 1.32"L RED MS	No	-	The lock washer has been updated on the data sheet to reflect the correct material description. The lens retaining ring UL rating has changed from UL 94-V0 to UL 94-HB.
LCS_132_YTP	LTP Rigid RND .313"D 1.32"L Yellow MS	No	-	The lock washer has been updated on the data sheet to reflect the correct material description. The lens retaining ring UL rating has changed from UL 94-V0 to UL 94-HB.
LCS_177_CTP	LTP Rigid Panel RND .313"D 1.77"L CLR MS	No	-	The lock washer has been updated on the data sheet to reflect the correct material description. The lens retaining ring UL rating has changed from UL 94-V0 to UL 94-HB.



FLX 442 Series

0.312" (7.94mm) Moisture Sealed Fresnel Lens Flexible Light Pipe



Easy panel installation – insert lens through panel hole from and from the back slide slip the lock washer onto lens barrel. While holding lens, twist on retaining ring one revolution until secure

Application

- Aircraft and Military
- Disinfection Environments
- Electrical Control Panels
- Industrial machinery
- Instrument Panels
- Signage
- Safety Applications
- Transportation Dashboards
- Vending and Gaming Machines

Key Features

- Lenses mount through a 5/16" (7.94mm) hole on 1/2" (6.35mm) centers
- Lens color available: green and clear
- Fiber optic: Ø 1.5mm optical core, Ø 2.2mm polyethylene cable jacket
- Lens mount: optical grade acrylic
- Led mounts: for SMD 22 & THR 22 - Nylon 66, UL rating 94-V2. For THR 5 22 - Nylon 66, UL rating 94-HB
- Lens: polycarbonate UL rating 94-V2
- Lens washer: CR steel, nickle plate
- Lens retaining ring: thermoplastic UL Rating 94-HB
- Lens seal: EPDM
- Optical core ends polished to 10 microns
- Mounts through front of panel. Secured by retaining ring
- Panel thickness 1/32" (0.79mm) to 1/8" (3.18mm)
- For best results use only narrow viewing angle non-diffused leds with output power greater than 100mcd
- U.S. and Foreign Pat. Issued
- For custom light pipe length contact VCC
- RoHS and REACH Compliant



Ordering Data

Part Number	Lens Type	Lens Color	Light Pipe Length
FLX_442_GTP_12	CMS 442, Moisture-sealed Fresnel	Green Transparent	12.0"
FLX_442_CTP_04	CMS 442, Moisture-sealed Fresnel	Clear Transparent	4.0"
FLX_442_CTP_06	CMS 442, Moisture-sealed Fresnel	Clear Transparent	6.0"
FLX_442_CTP_12	CMS 442, Moisture-sealed Fresnel	Clear Transparent	12.0"

Custom lengths available upon request

LED Adapter Options (Order Separately)



SMD 22
For SMD



THR_22
For T-1 LED



THR_5_22
For T-1 3/4 LED

Product Dimensions

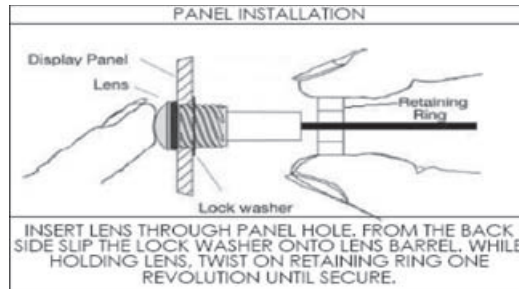
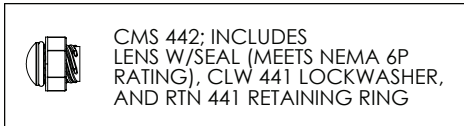
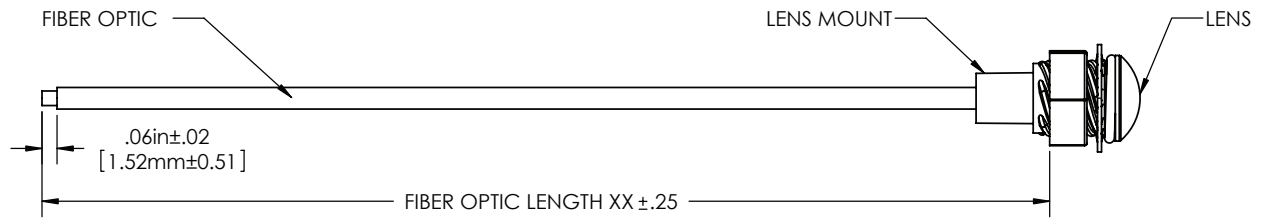

Notes:

1. All dimensions are in inches [millimeters]
2. Tolerance is $\pm .020$ [.508] unless otherwise noted

Product Specifications

Materials	
Fiber Optic	Ø 1.5mm optical core, Ø 2.2mm polyethylene cable jacket
Lens Mount	Optical grade acrylic
Lens	Polycarbonate UL rating 94-V2
Lens Retaining Ring	Thermoplastic UL Rating 94-HB
Lens Seal	EPDM
Lens Washer	CR Steel, Nickle Plate

Installation Specifications	
Mounting Hole	5/16" (7.94mm) hole on 1/2" (6.35mm) centers
Panel Thickness	1/32" (0.79mm) to 1/8" (3.18mm)

Compliances and Approvals



FLX 441 Series 0.312 (7.94mm) Fresnel Lens Flexible Light Pipe



Easy panel installation – insert lens through panel hole from and from the back slide slip the lock washer onto lens barrel. While holding lens, twist on retaining ring one revolution until secure

Application

- Aircraft and Military
- Disinfection Environments
- Electrical Control Panels
- Industrial machinery
- Instrument Panels
- Signage
- Safety Applications
- Transportation Dashboards
- Vending and Gaming Machines

Key Features

- Lenses mount through a 5/16" (7.94mm) hole on 1/2" (6.35mm) centers
- Lens color available: red
- Fiber optic: Ø 1.5mm optical core, Ø 2.2mm polyethylene cable jacket
- Lens mount: optical grade acrylic
- Led mounts: for SMD 22 & THR 22 - Nylon 66, UL rating 94-V2. For THR 5 22 - Nylon 66, UL rating 94-HB
- Lens: polycarbonate UL rating 94-V2
- Lens washer: CR steel, nickle plate
- Lens retaining ring: thermoplastic UL Rating 94-HB
- Lens seal: EPDM
- Optical core ends polished to 10 microns
- Mounts through front of panel. Secured by retaining ring
- Panel thickness 1/32" (0.79mm) to 1/8" (3.18mm)
- For best results use only narrow viewing angle non-diffused leds with output power greater than 100mcd
- U.S. and Foreign Pat. Issued
- For custom light pipe length contact VCC
- RoHS and REACH Compliant

Ordering Data

Part Number	Lens Type	Lens Color	Light Pipe Length
FLX_441_RTP_06	CMC 441, Standard Fresnel	Red Transparent	6.0"

Custom lengths available upon request

LED Adapter Options (Order Separately)



SMD 22
For SMD



THR_22
For T-1 LED



THR_5_22
For T-1 3/4 LED

Product Dimensions

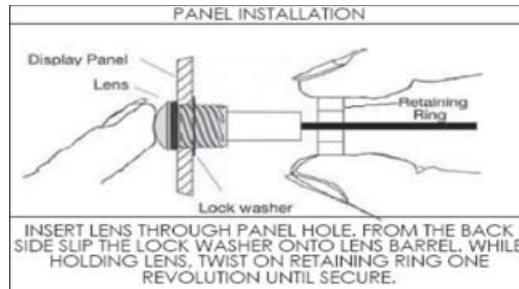
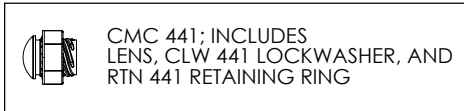
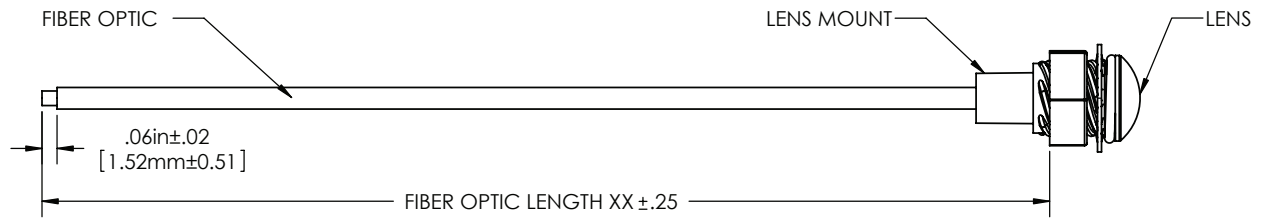

Notes:

1. All dimensions are in inches [millimeters]
2. Tolerance is ± .020 [.508] unless otherwise noted

Product Specifications

Materials	
Fiber Optic	Ø 1.5mm optical core, Ø 2.2mm polyethylene cable jacket
Lens Mount	Optical grade acrylic
Lens	Polycarbonate UL rating 94-HB
Lens Retaining Ring	Thermoplastic UL Rating 94-V0
Lens Seal	EPDM
Lens Washer	CR Steel, Nickle Plate

Installation Specifications	
Mounting Hole	5/16" (7.94mm) hole on 1/2" (6.35mm) centers
Panel Thickness	1/32" (0.79mm) to 1/8" (3.18mm)

Compliances and Approvals



CMS 444 Series 5MM Round Threaded Plain Lens With Seal



5mm Round standard threaded plain lens with seal

Notes

MOUNTING: Mounts in a $\text{Ø}.312\pm.002$ [$\text{Ø } 7.92\text{mm}\pm.05$] panel hole on $.500$ [12.7mm] centers. Panel thickness $.031$ [$.8\text{mm}$] to $.125$ [3.18mm]. Panel hole should be deburred, but not chamfered.

ASSEMBLY: Insert lens through panel hole, slide lock washer onto lens barrel and twist on retaining ring. PCB mounted LEDs slide into lens when the panel cover is closed or the PCB card is inserted into the case.

MATERIAL:

Lens-Polycarbonate, UL 94-V2

Lock Washer- CR Steel, Nickel plate

Retaining ring - Thermoplastic, U.L. 94-HB

Seal- EPDM

This is an assembly that used the RTN_441 retainer ring

Max torque nut should be tightened to is 1.8lb-in. (Product begins to fail at 3.2lb-in.)

U.S. & Foreign Pat. Issued & Pend.

Product Dimensions

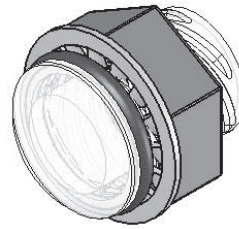
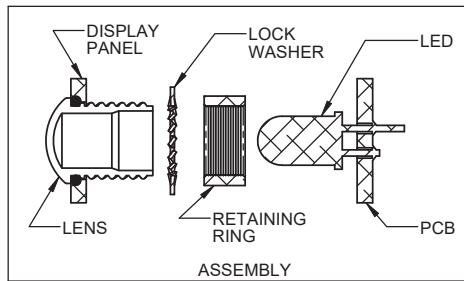
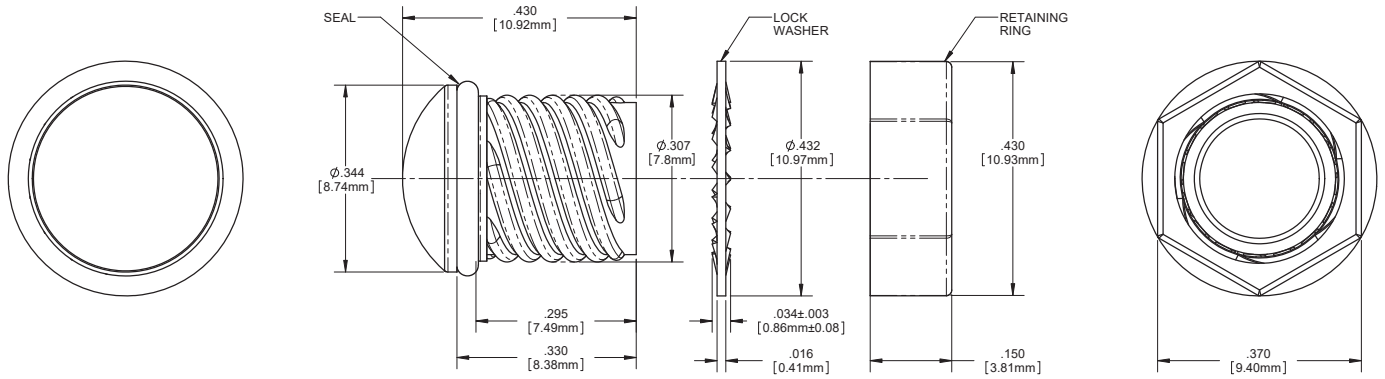

Ordering Data

ORDERING CODE : CMS 444 XXX

MODEL

LENS COLOR	
RTP	RED TRANSPARENT
ATP	AMBER TRANSPARENT
GTP	GREEN TRANSPARENT
BTP	BLUE TRANSPARENT
YTP	YELLOW TRANSPARENT
CTP	CLEAR TRANSPARENT

Compliances and Approvals



CMC 443 Series 5MM Round Threaded Plain Lens



5mm Round standard threaded plain lens

Notes

MOUNTING: Mounts in a $\text{Ø}.312\pm.002$ [$\text{Ø} 7.92\text{mm}\pm.05$] panel hole on $.500$ [12.7mm] centers. Panel thickness $.031$ [$.8\text{mm}$] to $.125$ [3.18mm]. Panel hole should be deburred, but not chamfered.

ASSEMBLY: Insert lens through panel hole, slide lock washer onto lens barrel and twist on retaining ring. PCB mounted LEDs slide into lens when the panel cover is closed or the PCB card is inserted into the case.

MATERIAL:

Lens-Polycarbonate, UL 94-V2

Lock Washer- CR Steel, Nickel plate

Retaining ring - Thermoplastic, U.L. 94-HB

This is an assembly that used the RTN_441 retainer ring

Max torque nut should be tightened to is 1.8lb-in. (Product begins to fail at 3.2lb-in.)

U.S. & Foreign Pat. Issued & Pend.

Product Dimensions

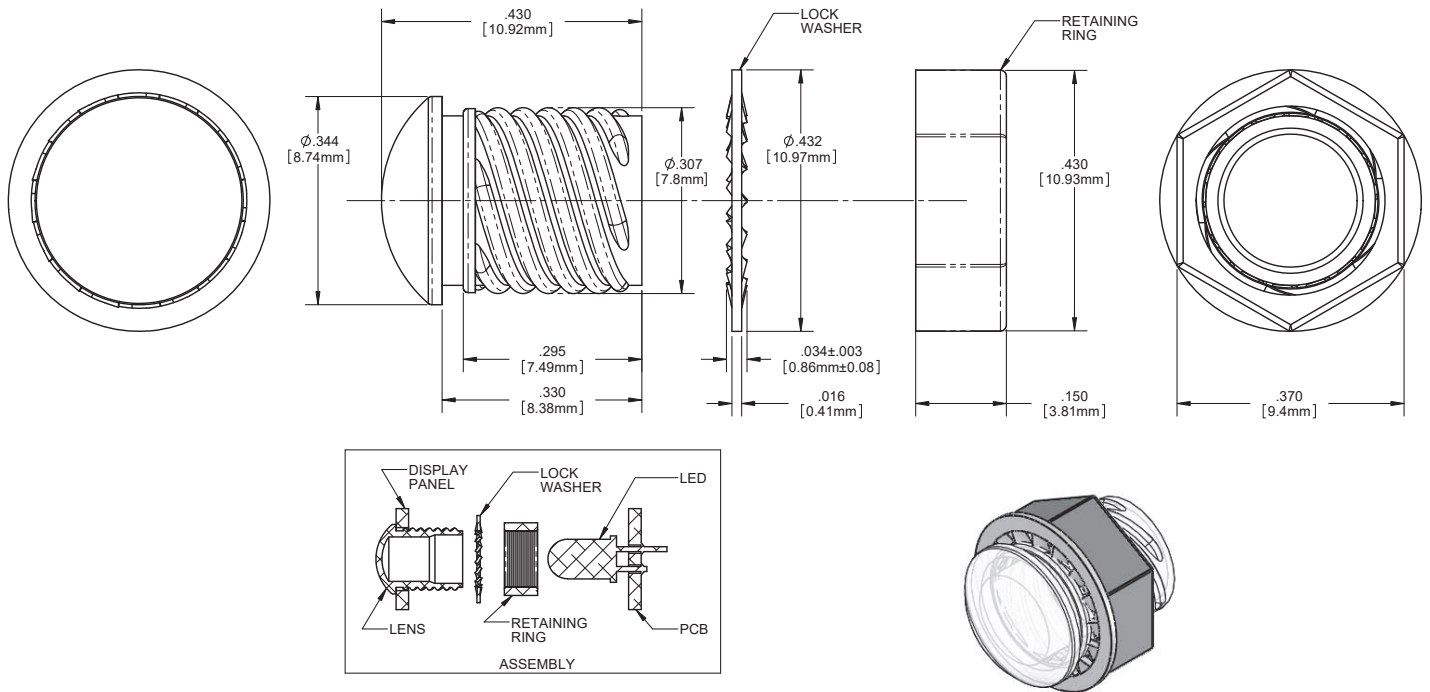

Ordering Data

ORDERING CODE : CMC 443 XXX

MODEL

LENS COLOR	
RTP	RED TRANSPARENT
ATP	AMBER TRANSPARENT
GTP	GREEN TRANSPARENT
BTP	BLUE TRANSPARENT
YTP	YELLOW TRANSPARENT
CTP	CLEAR TRANSPARENT

Compliances and Approvals



CMS 442 Series 5MM Round Threaded Fresnel Lens With Seal



5mm Round standard threaded fresnel lens with seal

Notes

MOUNTING: Mounts in a $\text{Ø}.312\pm.002$ [$\text{Ø} 7.92\text{mm}\pm.05$] panel hole on $.500$ [12.7mm] centers. Panel thickness $.031$ [$.8\text{mm}$] to $.125$ [3.18mm]. Panel hole should be deburred, but not chamfered.

ASSEMBLY: Insert lens through panel hole, slide lock washer onto lens barrel and twist on retaining ring. PCB mounted LEDs slide into lens when the panel cover is closed or the PCB card is inserted into the case.

MATERIAL:

Lens-Polycarbonate, UL 94-V2

Lock Washer- CR Steel, Nickel plate

Retaining ring - Thermoplastic, U.L. 94-HB

Seal- EPDM

This is an assembly that used the RTN_441 retainer ring

Max torque nut should be tightened to is 1.8lb-in. (Product begins to fail at 3.2lb-in.)

U.S. & Foreign Pat. Issued & Pend.

Product Dimensions

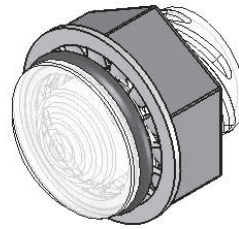
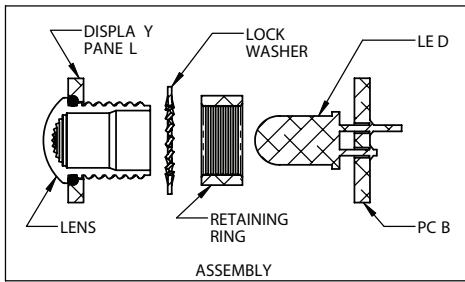
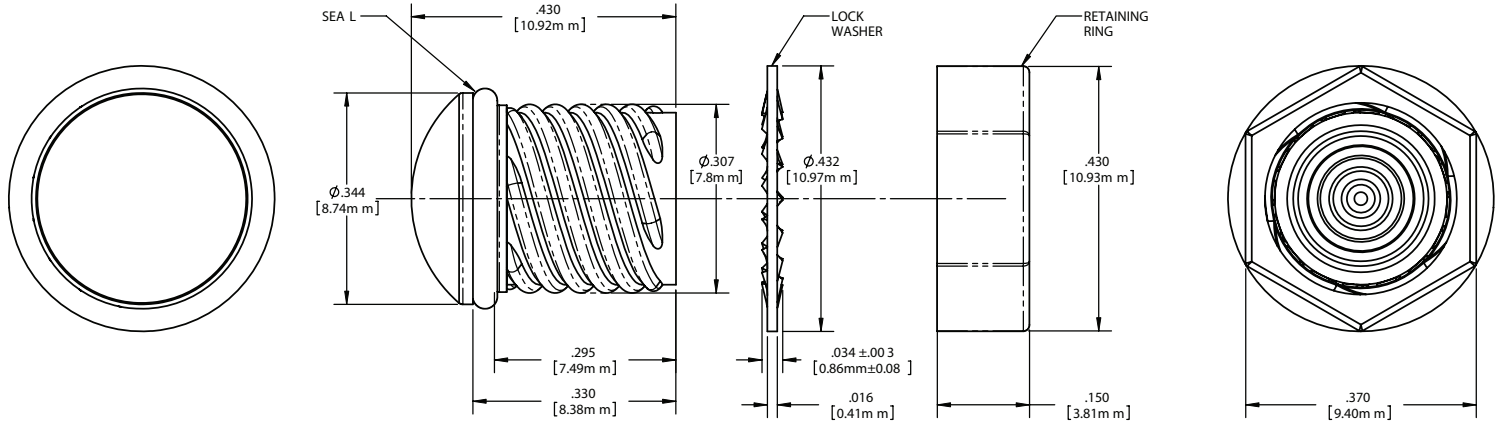

Ordering Data

ORDERING CODE : CMS 442 XXX

MODEL

LENS COLOR	
RTP	RED TRANSPARENT
ATP	AMBER TRANSPARENT
GTP	GREEN TRANSPARENT
BTP	BLUE TRANSPARENT
YTP	YELLOW TRANSPARENT
CTP	CLEAR TRANSPARENT

Compliances and Approvals



CMC 441 Series 5MM Round Threaded Fresnel Lens



5mm Round standard threaded fresnel lens

Notes

MOUNTING: Mounts in a $\text{Ø}.312\pm.002$ [$\text{Ø} 7.92\text{mm}\pm.05$] panel hole on $.500$ [12.7mm] centers. Panel thickness $.031$ [$.8\text{mm}$] to $.125$ [3.18mm]. Panel hole should be deburred, but not chamfered.

ASSEMBLY: Insert lens through panel hole, slide lock washer onto lens barrel and twist on retaining ring. PCB mounted LEDs slide into lens when the panel cover is closed or the PCB card is inserted into the case.

MATERIAL:

Lens-Polycarbonate, UL 94-V2

Lock Washer- CR Steel, Nickel plate

Retaining ring - Thermoplastic, U.L. 94-HB

This is an assembly that used the RTN_441 retainer ring

Max torque nut should be tightened to is 1.8lb-in. (Product begins to fail at 3.2lb-in.)

U.S. & Foreign Pat. Issued & Pend.

Product Dimensions

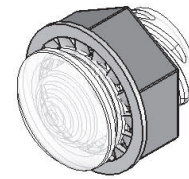
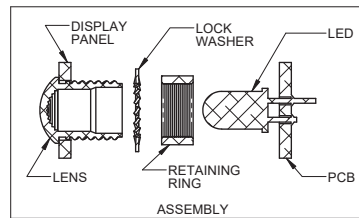
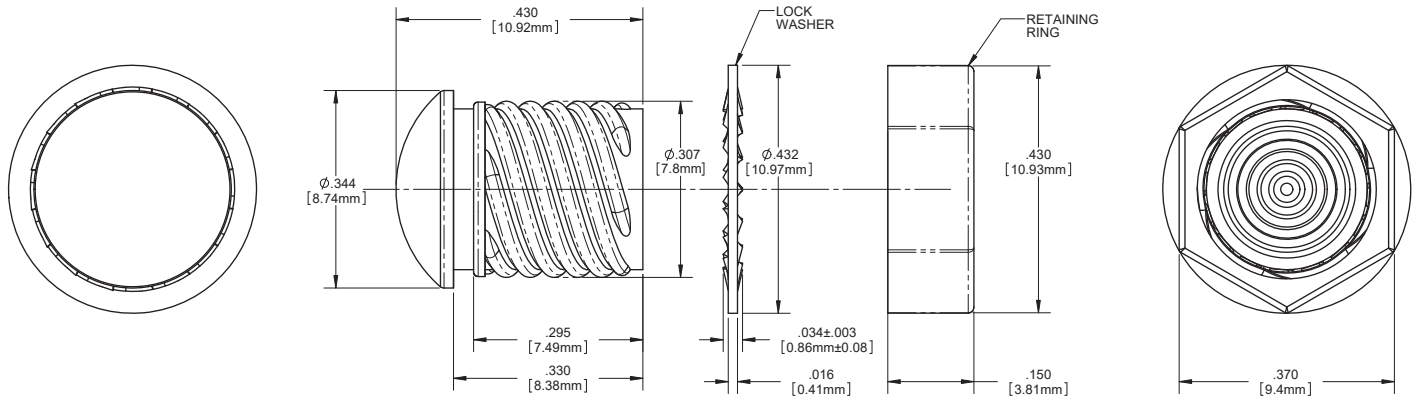

Ordering Data

ORDERING CODE : CMC 441 XXX

MODEL

LENS COLOR	
RTP	RED TRANSPARENT
ATP	AMBER TRANSPARENT
GTP	GREEN TRANSPARENT
BTP	BLUE TRANSPARENT
YTP	YELLOW TRANSPARENT
CTP	CLEAR TRANSPARENT

Compliances and Approvals



LCS Series

0.313" (7.95mm)

Moisture Sealed Rigid Light Pipe



Key features

1. **Mounting:** Mounts in a \varnothing 0.313"~0.337"(7.95mm~8.55mm) panel hole on .500" (12.7mm) centers. Panel thickness .031" (.8mm) to .125" (3.18mm).
2. **Assembly:** Insert lightpipe through the panel hole, slide lock washer onto lens barrel on lightpipe and twist on retaining ring. Slide PCB into position aligning LED with the end of the lightpipe unit.
3. **Material:** Lightpipe - Acrylic (Clear optical grade) UL 94-HB
Lens - Polycarbonate UL 94-V2
Seal - EPDM
Retaining Nut - Thermoplastic (white) UL 94-HB
Lock Washer - CR Steel, Nickel Plate
4. Meets NEMA 6P/IP 67 standards
5. Viewing Angle: 60°
6. Max torque nut should be tightened to is 1.8lb-in. (Product begins to fail at 3.2lb-in)
7. Operating Temperature range: -40C to 102C
 - Light pipe: -40C ~ 102C
 - Lens: -40C ~ 126C
 - Seal(EPDM 70A): -53.8C ~ 148.8C
 - Nut: -60C ~ 120C
 - Washer(CR steel)

Product Dimensions

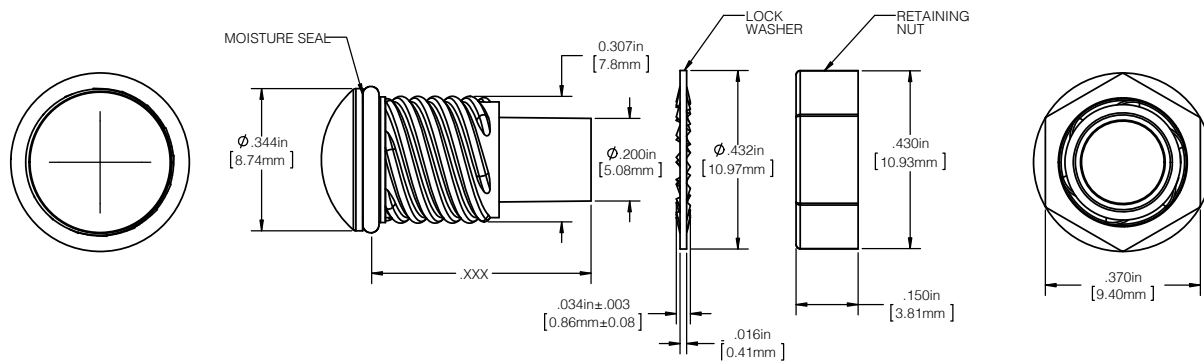

Ordering Code: LCS

Lightpipe	
	Length
032	.320"
052	.520"
072	.720"
092	.920"
112	1.12"
132	1.32"
177	1.77"

Lens	
	Color
RTP	Red Transparent
ATP	Amber Transparent
GTP	Green Transparent
BTP	Blue Transparent
YTP	Yellow Transparent
CTP	Clear Transparent

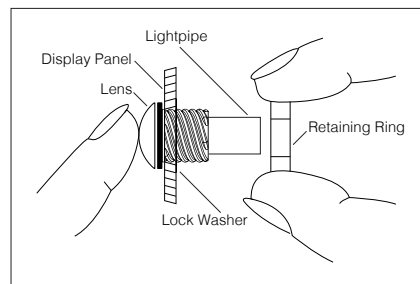

Dimensions Style Inches [MM] General Tolerances Unless Otherwise Specified		
	Inches	Length
.X	± .020	± .508
.XX	± .015	± .381
.XXX	± .005	± .127
Angle ± 1°		
Break All Corners And Sharp Edges .030 Max		
 Third Angle Projection		

Note: LCS_032_BTP not available

Product Specifications

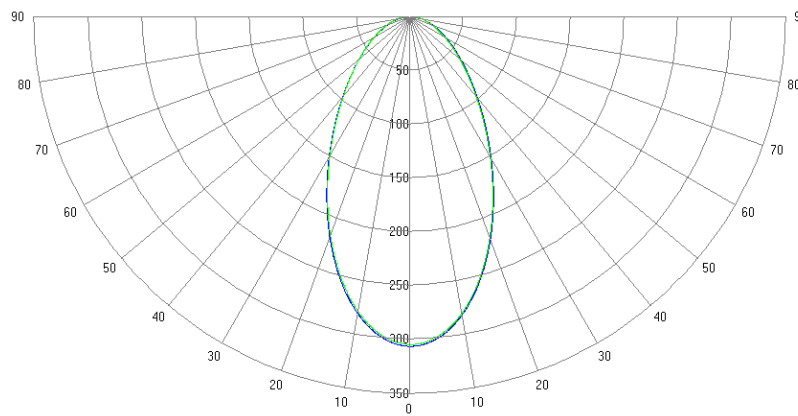

Viewing Angle: 60°