



**A DIVISION OF EDAC (AMERICA) LIMITED**

3300 Int'l Airport Dr., Ste. 200, Charlotte, NC 28208 (704) 424-5448 Fax: (704) 424-5648 www.norcomp.net

**(Product Change Notification)**

Wednesday, March 25, 2015

PCN# 030115

To Whom It May Concern:

Please be advised NorComp has made a change to item numbers listed on the next page. Our records show that you have purchased some of these products in the last 5 years. Updated drawings are located on page 3 & 4 of this PCN and on the NorComp web site at [www.norcomp.net](http://www.norcomp.net).

**Change Description:** In order to provide consistent colors in our 972 series hoods/backshells, Norcomp has established "Pantone Color Numbers" for this series. We will begin shipping the new "Pantone Colors" over the next 3 months.

We appreciate your understanding as we strive to offer you the most current information regarding our product.

Please confirm receipt & acceptance of product change notification (by returning signed copy by fax or email) and contact us if you need any additional assistance.

Regards,  
Matt Sigmon  
Product Engineer  
Fax: 704-424-5648

Approved By: \_\_\_\_\_

Company: \_\_\_\_\_

Title: \_\_\_\_\_

Date: \_\_\_\_\_

972-009-01SR011  
972-015-01SR011  
972-025-01SR011  
972-037-01SR011

972-009-01SR031  
972-015-01SR031  
972-025-01SR031  
972-037-01SR031

972-009-01SR041  
972-015-01SR041  
972-025-01SR041  
972-037-01SR041

972-009-01SR061  
972-015-01SR061  
972-025-01SR061  
972-037-01SR061

972-009-01SR071  
972-015-01SR071  
972-025-01SR071  
972-037-01SR071

972-009-01SR081  
972-015-01SR081  
972-025-01SR081  
972-037-01SR081

972-009-01SR111  
972-015-01SR111  
972-025-01SR111  
972-037-01SR111

**DESCRIPTION: 972 SERIES D-SUB SLIM-LINE BACKSHELL**

**BACKSHELL KIT INCLUDES:**

- (1) BACKSHELL
- (2) 4-40 THUMBSCREWS
- (1) PLASTIC STRAIN RELIEF
- (1) METAL STRAIN RELIEF CLAMP
- (2) STRAIN RELIEF SCREWS

**TORQUE VALUE ON PLASTIC FOR STRAIN RELIEF SCREWS = 4 INCH POUNDS MAX.**

972-YYY-01SRY1

SERIES \_\_\_\_\_  
 POSITIONS \_\_\_\_\_  
 009  
 015  
 025  
 037  
 MATERIAL \_\_\_\_\_  
 01S = PLASTIC/SLIM LINE  
 COLOR: \_\_\_\_\_  
 01 = BLACK  
 03 = LIGHT GREY  
 04 = GREEN  
 06 = RED  
 07 = BLUE  
 08 = YELLOW  
 11 = DEC GREY  
 PUT-UPS \_\_\_\_\_  
 1 = KIT

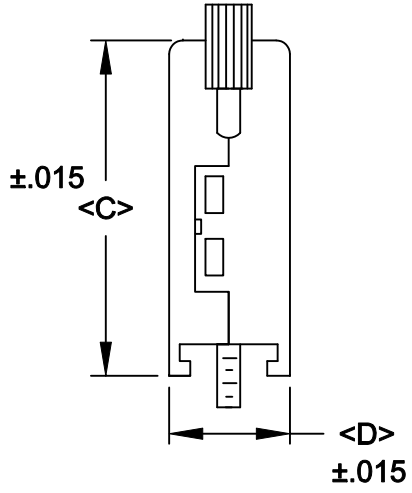
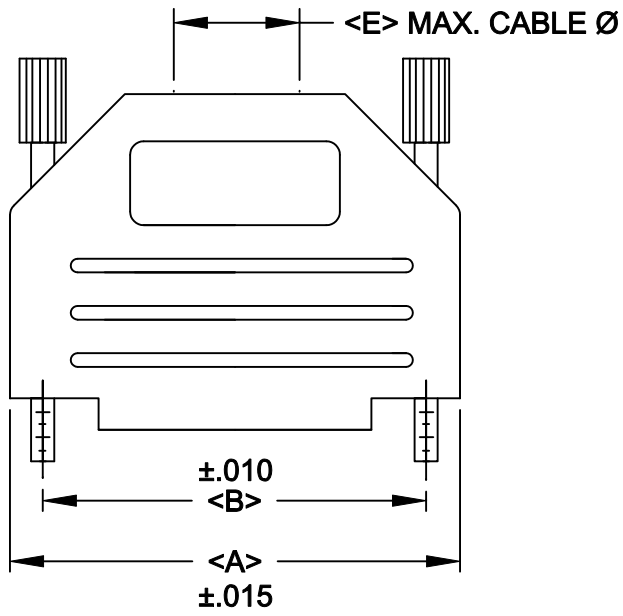

**\*\*SEE PAGE 2 FOR PANTONE COLOR CODES**

POS.	A	B	C	D	E
9	1.240	.984	1.339	.591	.315
	31.50	24.99	34.00	15.00	8.00
15	1.575	1.312	1.339	.591	.453
	40.00	33.32	34.00	15.00	11.50
25	2.106	1.852	1.575	.591	.453
	53.50	47.04	40.00	15.00	11.50
37	2.795	2.500	1.575	.591	.453
	71.00	63.50	40.00	15.00	11.50

**MATERIAL: POLYAMIDE PA66 - UL 94H-B**  
**MANY COLORS AVAILABLE**

**THUMBSCREWS: STEEL**

**OPERATING TEMP: -30°C TO +110°C**  
**RoHS COMPLIANT**

	THESE DRAWINGS AND SPECIFICATIONS ARE THE PROPERTY OF NorComp AND SHALL NOT BE REPRODUCED, COPIED OR USED AS THE BASIS FOR THE MANUFACTURE OF SALE OF APPARATUS WITHOUT WRITTEN PERMISSION.		DRAWN: <b>PAM JENKINS</b>	DATE: <b>6-10-05</b>
			CHECKED:	DATE:
<h1>NorComp</h1>		SCALE:	SHEET <b>1</b> OF <b>2</b>	REV <b>5</b>
		DWG NO. <b>972-YYY-01SRY1</b>		

COLOR RANGE		
COLOR	UPPER	LOWER
01 = BLACK	PANTONE BLACK 3C	PANTONE BLACK 3C
03 = LIGHT GREY	427C	427C
04 = GREEN	7731C	7732C
06 = RED	186C	187C
07 = BLUE	2190C	2191C
08 = YELLOW	108C	109C
11 = DEC GREY	7527C	7534C



THESE DRAWINGS AND SPECIFICATIONS ARE THE PROPERTY OF NorComp AND SHALL NOT BE REPRODUCED, COPIED OR USED AS THE BASIS FOR THE MANUFACTURE OF SALE OF APPARATUS WITHOUT WRITTEN PERMISSION.

DRAWN:

PAM JENKINS

DATE:

6-10-05

CHECKED:

DATE:

SCALE:

SHEET

OF

2

2

REV

5

DWG NO.

972-YYY-01SRYY1

# NorComp